

THE BOROUGH OF PALISADES PARK ZONING BOARD OF ADJUST. APPROVED THIS PLAN BY MEMORIALIZING RESOLUTION AT ITS REGULAR MEETING ON _____ PLEASE SEE AFFIXED RESOLUTION FOR ANY ADDITIONAL CONDITIONS OF APPROVAL SET BY THE BOARD

BOARD ENGINEER _____ DATE _____

BOARD SECRETARY _____ DATE _____

BOARD CHAIRPERSON _____ DATE _____

Architect shall not be responsible for the means & methods of construction and or site maintenance & safety

PROJECT:
 Proposed New:
Four Unit Townhouse Dwelling
 22 West Washington Place
 @ Corner of Highland Ave.
 Palisades Park, New Jersey
 Block: 218 Lot: 1
 AA Zone

COPYRIGHT © 2017, VASSILIOS COCOROS ARCHITECT - ALL RIGHTS RESERVED. THE COPYING OR REUSE OF THIS DOCUMENT OR PORTIONS THEREOF FOR OTHER THAN THE ORIGINAL PROJECT OR THE PURPOSE ORIGINALLY INTENDED WITHOUT WRITTEN PERMISSION OF VASSILIOS COCOROS ARCHITECT IS PROHIBITED.

Date	Item
05/27/20	CLIENT REVIEW

DRAWING TITLE:
FLOOR PLANS

SCALE: AS NTD. DATE: 8/30/19

DESIGNED BY: VC PROJECT#: RSN-19-14

DRAWN BY: VC CAD FILE:

CHECKED BY: VC DRAWING #:

PROFESSIONAL SEAL: DRAWING:

A3

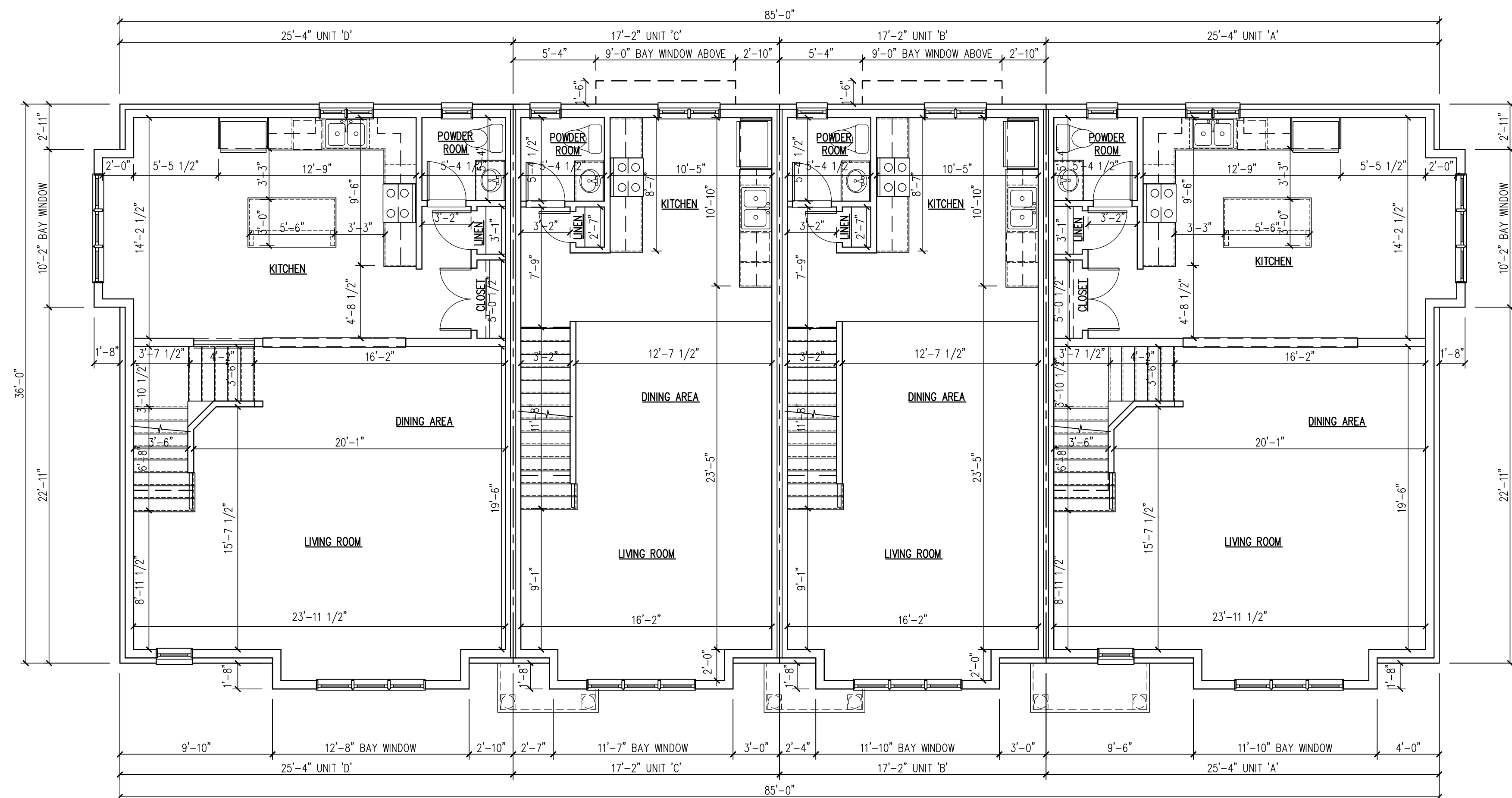

FIRST FLOOR PLAN 3,174 SQUARE FEET
 SCALE: 3/16" = 1'-0"

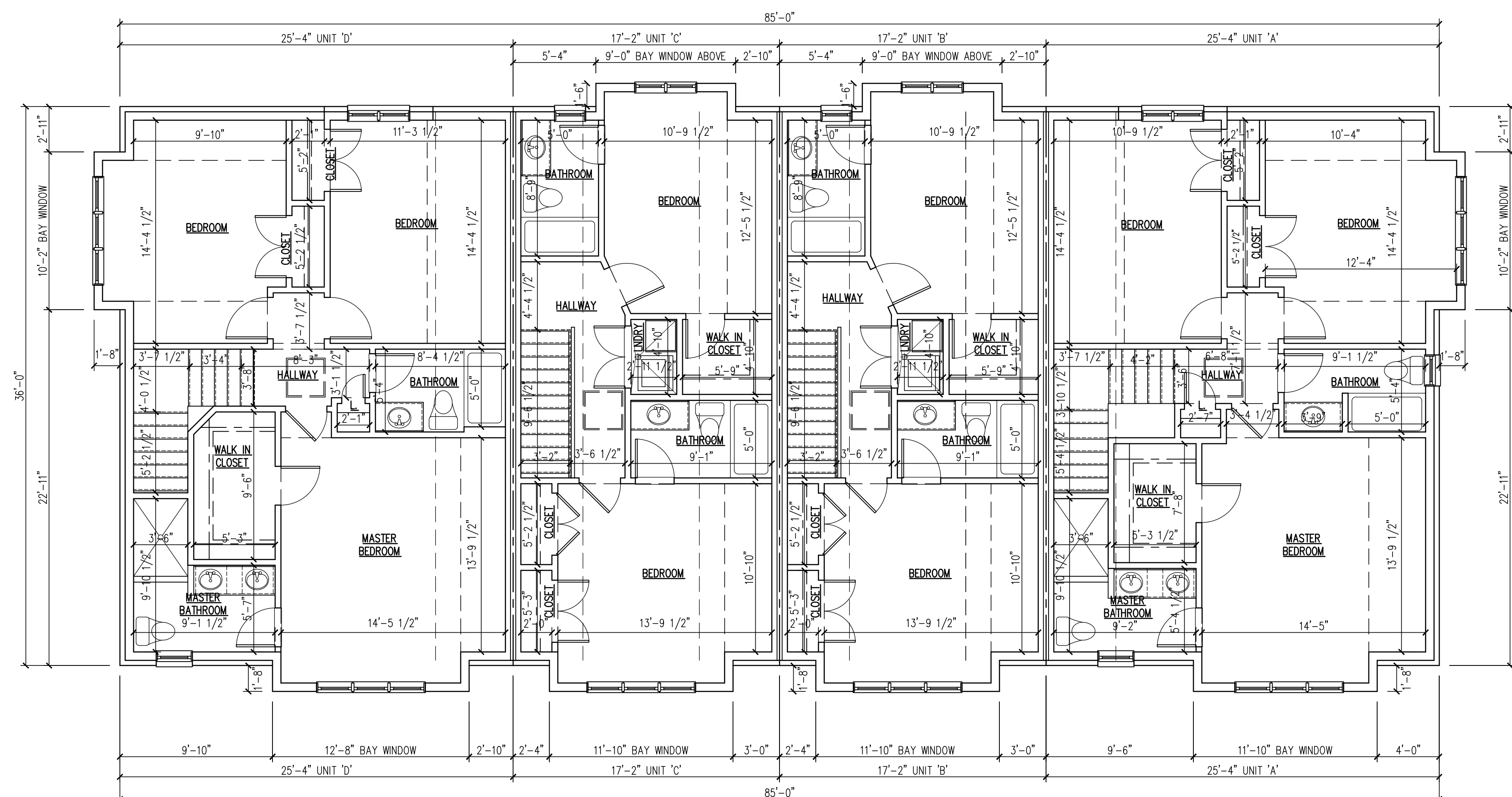

SECOND FLOOR PLAN 3,201 SQUARE FEET
 SCALE: 3/16" = 1'-0"